

Heavy Square Washer

Material: Mild Steel

Class Grade: Low Tensile Class 4.6

Corrosion Protection Level: Moderate

Finish: Zinc Yellow

Standard: HEC Standard

System Of Measurement: Metric

Comments: Washers are not precision items. Dimensional data should be used as a guide only.

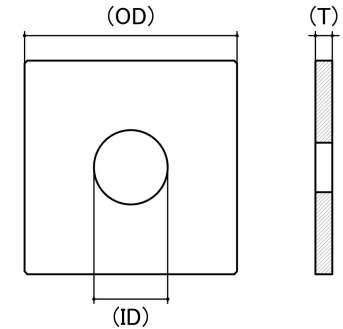

*Cad Drawings shown for graphic representation only.**

Industry Size	Inside Dimension (ID) (mm)		Outside Dimension (OD) (mm)	Thickness (T) (mm)		sku (Part Number)
	Min	Max		Min	Max	
M10 x 38 x 38 x 3	10.70	11.70	38 x 38	2.60	3.00	71HS1038383
M10 x 50 x 50 x 3	10.70	11.70	50 x 50	2.60	3.00	71HS1050503
M12 x 50 x 50 x 3	13.10	14.20	50 x 50	2.60	3.00	71HS1250503
M12 x 50 x 50 x 5	13.10	14.20	50 x 50	4.30	5.00	71HS1250505
M16 x 50 x 50 x 5	16.80	18.60	50 x 50	4.30	5.00	71HS1650505
M16 x 65 x 65 x 5	16.80	18.60	65 x 65	4.30	5.00	71HS1665655

Disclaimer:

Dimensional data and technical information was obtained from publically available sources and not acquired through standard agencies. It has been completed and compiled for reference purposes only; where discrepancies are found they are subject to change without notice. Bolt & Nut Australia makes no warranties or representations regarding the accuracy and validity of the compiled information and data. Contact the relevant standard authorities for accurate and detailed information.

* Cad Drawings may not reflect diameter, thread length or overall length.

© Bolt & Nut Australia Pty Ltd. All rights reserved.

Version: 09 Aug 2024